

Brunswick®

-International Series-

Express Zone® H

PowerKoil 24 Reactive

Part Number

60-104636-93X

Coverstock

PowerKoil 24 - Reactive

Color: Black / Green Solid

Hardness: 76-78

Factory Finish

400-grit wet sand

Core Dynamics

RG Max: 2.539

RG Min: 2.497

RG Diff: 0.042

Average RG: 3.4 of 10

Performance

Hook Potential: 155

Length: 75

Breakpoint Shape: 70

Available Weights

11-16 Pounds

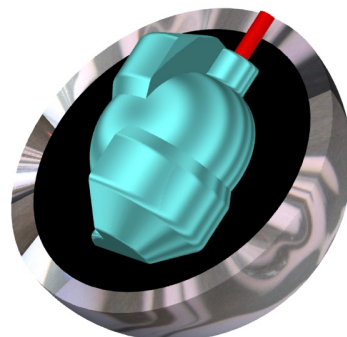

Hook Potential:



Length:



Breakpoint Shape



Flare Potential:



RG-Average:

Brunswick's International Series has been developed specifically for Asian markets using core and coverstock systems that provide Asian bowlers with a range of equipment that matches up to typical Asian lane conditions. The looks of International Series balls are also adapted to Asian tastes making the International Series completely customized for Asian bowlers. Available only through International Distributors.

Reaction Characteristics – Express Zone H

To describe the **International Series** better we have labeled the balls with either an **S** or **H**.

- **S** will describe **Strong** reaction on the backend.
- **H** will describe **High** hooking reaction in the mid-lane.

The **Express Zone H** uses the **Popular Inferno** Low-RG Symmetrical Core Shape System combined with a non-pearlized, two-color **High Traction PowerKoil 24** coverstock. This core/coverstock combination creates a large hook potential, Strong arcing reaction that matches up on medium to oily lane conditions and longer patterns. Bowlers with faster ball speeds or any bowler who has problems with the ball going too long before hooking should appreciate the ball reaction of the **Express Zone H**. This ball is designed for bowlers looking for Aggressive hooking action on Long Oil patterns.

Utility – Express Zone H

• **Out of the box:** With its dull 400-grit wet sand surface the **Express Zone H** matches up well on medium to oily lane conditions.

• **When shined:** Using Brunswick's **Factory Finish High Gloss Polish or Rough Buff**, the total hooking action of the **Express Zone H** can be reduced and the arc made more skid/snap. Both polishes reduce hooking action in the oil and increase reaction on dry back-ends. The **Rough Buff** provides a moderate amount of change. The **High Gloss Polish** a greater amount of change.

Reaction Setup – Express Zone H

The **Express Zone H** can be drilled using the standard drilling techniques developed for two-piece balls. See the included drilling instructions for reaction characteristics and layout details.

The **Express Zone H** is finished with a dull 600-grit surface finish which increases its hooking action in the oil. Dull surface finishes can sometimes hook too early resulting in reduced backend reaction and hitting power. To increase length, polish the surface with Brunswick's **Factory Finish Rough Buff or Factory Finish High Gloss Polish** available at your local Pro Shop.

For the most up to date Product Line Information go to www.brunswickbowling.com

High-Differential Symmetric Core Layout Sheet

(RGdiff. 0.040 and above)

Earlier Rolling Reactions

High Flare High Hook Potential

Later Rolling Reactions

1E (Heavy Oil)

Maximum hook potential for **Medium-Low RPM** players.

This layout may hook early and be inconsistent at the breakpoint for **High-RPM** players, use layout #2E instead.

This layout may hit the finger holes for **High-Track** players, use layout #1L instead.

1L (Heavy Oil)

Maximum hook potential with less mid-lane and more backend than layout #1E for **Medium-Low RPM** players

This layout may hook early and be inconsistent at the breakpoint for **High-RPM** players, use layout #2L instead.

2E (Medium Oil)

Maximum hook potential for **High-RPM** players

Medium hook potential for **Medium-Low RPM** players

This layout may hit the finger holes for **High-Track** players, use layout #2L instead.

2L (Medium Oil)

Maximum hook potential for **High-RPM** players.

Medium hook potential for **Medium-Low RPM** players

Less mid-lane and more backend than layout #2E.

3E (Oily Wet/Dry's)

Pin between axis and leverage for medium hook potential and early roll.

Helps moderate over reactions.

This layout may lack hitting power for **Medium-Low RPM** players.

3L (Hooking heads)

High RG pin position with the pin above the fingers for length. X-hole positioned for increased flare.

Moderate hook potential with skid/snap arc to fight early hook in the heads.

Lower hook potential than layout #2L.

4E (Hooking Wet/Dry's)

Smooth reaction for moderating wet/dry lane conditions

Lower hook potential than layout #3E.

This layout may hit the finger holes for **High-Track** players, use layout #4L instead.

4L (Dry lanes)

Minimum hook potential for dry lanes and moderating over reactions.

High RG pin position with the pin above the fingers for length

Low Flare Low Hook Potential

Note: Finger, thumb and X-holes must have at least a moderate bevel and the riser Pin (P) must be at least one inch from any drilled hole to comply with the Brunswick warranty